

## ArcSystem with V2R1 or V2R2

Compact arc welding system for high volume production.

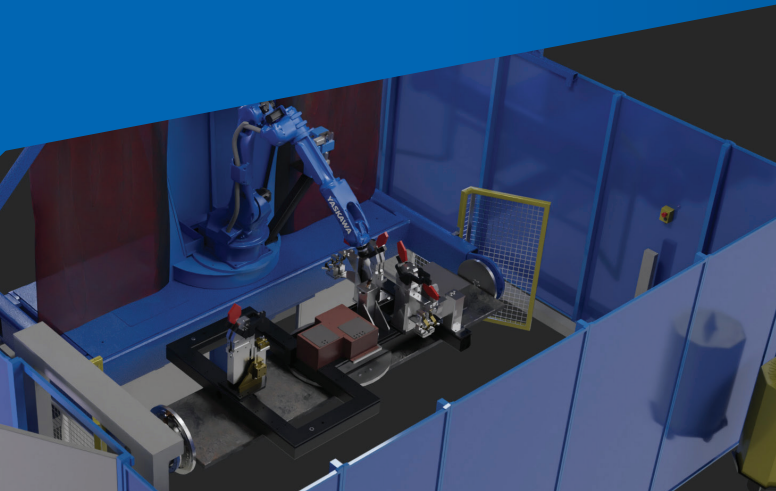

### Key benefits

- Small footprint.
- High output.
- Short delivery times.
- Easy to install and relocate.

ArcSystem with the compact positioner with robots on board is designed for a high volume production of large and heavy workpieces and optimised cycle times. Large objects can be loaded with an overhead crane. It is suitable for TIG or MIG/MAG welding. Our standard configurations are designed for workpieces up to 1500 kg, three meters long and a clamping fixture width of up to 1600 mm.

### Scope of delivery

- MOTOMAN arc welding robot.
- YRC1000 control cabinet.
- RWV2 compact positioner.
- Sheet metal safety fence with light curtain or light beam.
- Interlocked service door.
- Operational panel with PLC.

### Options

- Single or twin robot system.
- Basic PLC system with 9" HMI.
- Exhaust fume hood.
- Loading area with rapid roller door.
- Endless JIG rotation.
- Media supply to fixtures: permanent air connection; permanent & safety air connection to JIG + 16 digital IO signals; permanent & safety air connection to JIG + profinet interface.

### Many advantages

The innovative positioner with robots mounted on top has many advantages. Not only does it reduce the footprint of the whole robot system, it also facilitates the access to the workpiece during programming and welding. If the robot system needs to be relocated this fixed position of robot and positioner means that it is not necessary to re-teach the robot jobs.

### Single or twin robot system

This ArcSystem is available with a single robot or two robots working together. The twin robot system provides additional advantages when it comes to reducing cycle times, increasing the output and handling complicated workpieces.

Controlled by  
YRC1000

New generation  
Sigma-7

# ArcSystem V2R1 and V2R2

## ArcSystem V2R1

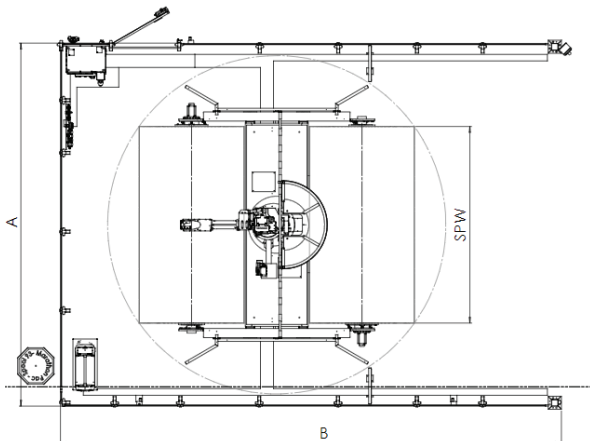
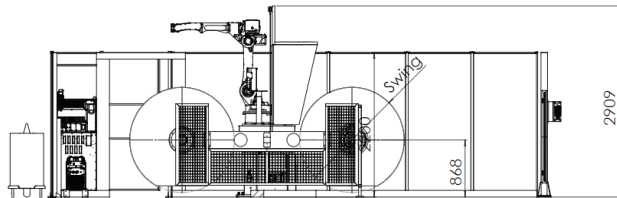

## ArcSystem V2R2

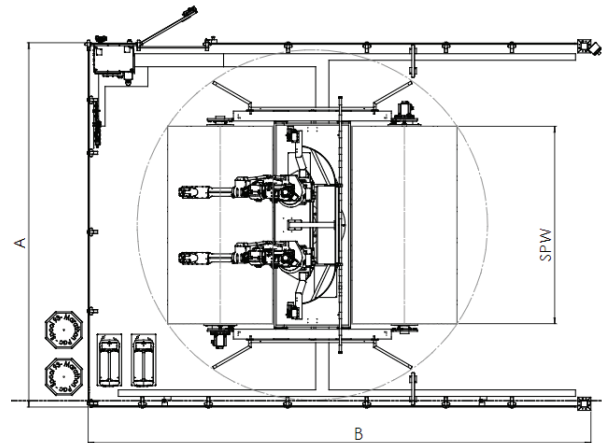
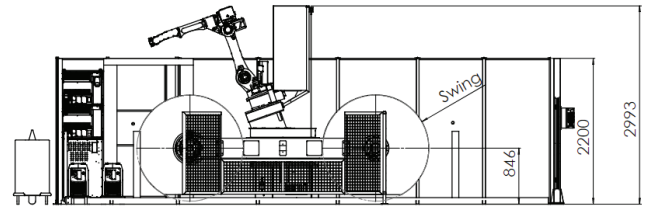

All dimensions are for reference only. Request detailed drawings for design/engineering requirements!

Technical data	ArcSystem with V2R1 *) and V2R2 **)							
<b>Payload</b>	1000 kg				1500 kg			
<b>Robot</b>	AR2010				AR2010			
<b>Positioner</b>	RWV2				RWV2			
<b>Fixture diameter</b>	1200	1600	1200	1600	1200	1600	1200	1600
<b>Fixture width</b>	2500	3000	2500	3000	2500	3000	2500	3000
<b>System width (A)</b>	4350	4850	5150	5550	4850	5150	5500	5500
<b>System length (B)</b>	6100	6900	7300	7500	6900	7300	7500	7500

\*) single robot

\*\*) twin robot

### YASKAWA Headquarters

YASKAWA Europe GmbH  
Robotics Division  
Yaskawastraße 1  
85391 Allershausen  
Tel. +49 (0) 8166/90-0  
Fax +49 (0) 8166/90-103

robotics@yaskawa.eu  
www.yaskawa.eu

### Yaskawa Academy

Yaskawa Europe GmbH  
Philipp-Reis-Straße 6  
65795 Hattersheim am Main  
Tel. +49 (0) 6196/77725-0  
Fax +49 (0) 6196/77725-39

Technical data may be subject to change without previous notice.  
© YASKAWA Nordic AB · RegNo. 6646EN-01, October 2024

# YASKAWA